

- NOTE:
- Proposals must comply with all acoustic, fire & building regulation requirements
 - No dimensions are to be scaled from this drawing. The contractor is responsible for checking all dimensions on site

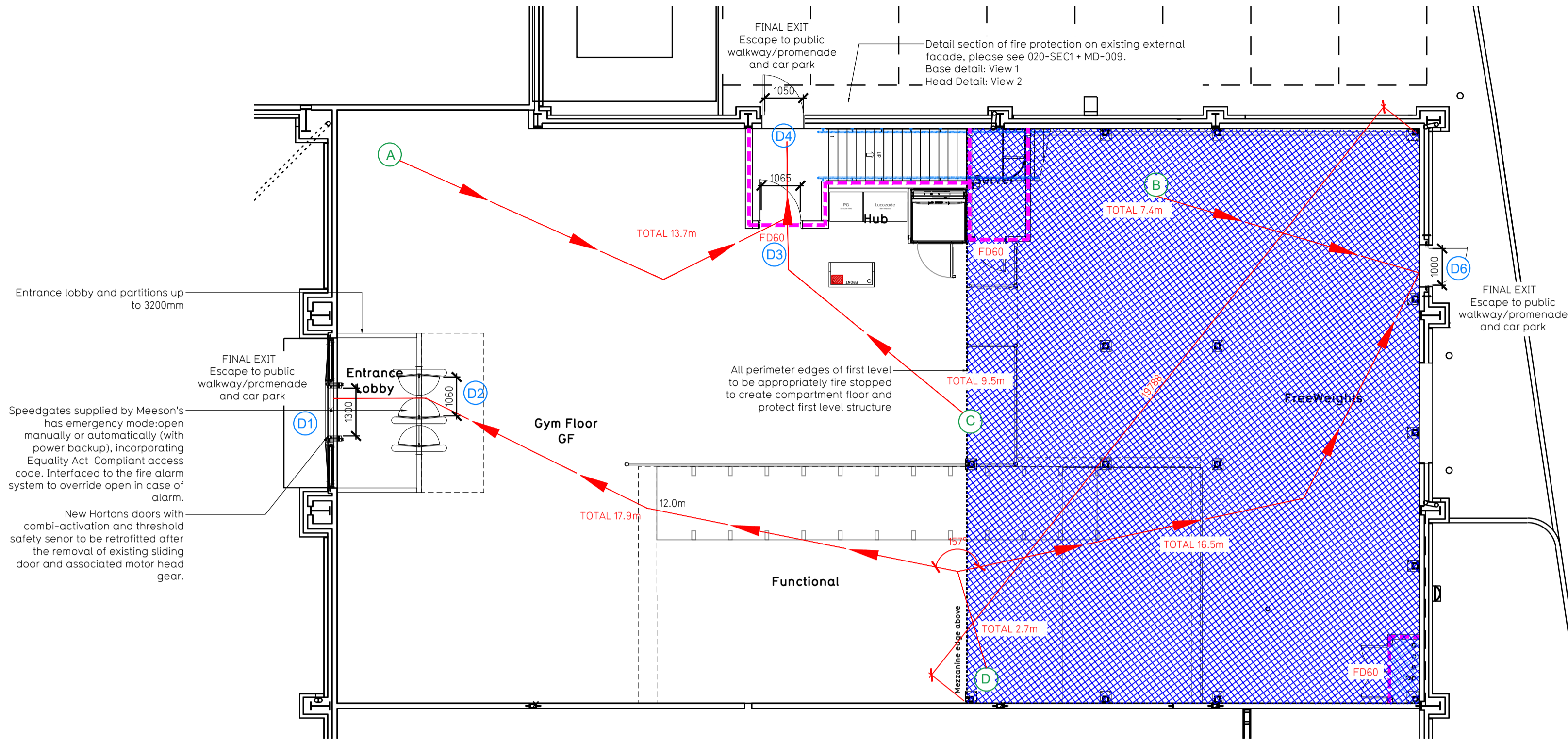

Proposed Ground Floor Plan

Escape Route Widths

In line with Section 2.9.8 of the Technical Handbook - Non Domestic, the aggregate unobstructed width in mm of all escape routes from a room, or storey, should be at least 5.3 x the occupancy capacity of the room or storey.

Ground Floor

Aggregate Clear Opening Width of Escape Routes Calculation:
 Final Fire Exit DR1, clear opening width = 1300mm
 Final Fire Exit DR4, clear opening width = 1050mm
 Final Fire Exit DR6, clear opening width = 1000mm

Total Aggregate Width for Ground Floor 3350mm (Less Largest Opening Width 1300mm from Fire Exit DR1) = 2050mm

Ground Floor Maximum Occupancy Capacity = 2050 / 5.3 = 386 people

First Floor

Aggregate Clear Opening Width of Escape Routes Calculation:
 Storey Exit DR9, leading to Final Fire Exit DR4 at GF level = 924mm

Total Aggregate Width for First Storey 924mm

First Floor Maximum Occupancy Capacity = 924 / 5.3 = 174 people

Due to use of a single mean of escape from first level, occupancy from first level is restricted to 60 person in accordance with Section 2.9.7 of the Technical Handbook - Non Domestic. This will be achieved by 24/7 CCTV monitoring and on-site staff management.

Combined Occupancy Provision

Ground floor maximum occupancy: 386
 First floor maximum occupancy: 60
 Total occupancy provision: 446

Based on PG existing occupancy data of comparable sites, the average total occupancy of a Pure Gym at this size will NOT exceed 70 people (including staff), which is smaller than the max. no of 446 persons (see calculation above) and is therefore thought to meet with the Section 2.9 of Technical Handbook - Non Domestic.

Escape Distance and Angle of Divergence

Position A
 Total escape distance to nearest Final Exit DR4 = 13.7m
 The total escape distance is less than 15m and thus complies.

Position B
 Total escape distance to nearest Final Exit DR4 = 7.4m
 The total escape distance is less than 15m and thus complies.

Position C
 Total escape distance to nearest Final Exit DR4 = 9.5m
 The total escape distance is less than 15m and thus complies.

Position D
 Total escape to nearest Final Exit DR6 = 19.2m
 Distance before divergence is 2.7m
 A.O.D to be > (2.5 x 2.7) + 45 = 51.75°
 Drawn A.O.D = 15° thus complies

Position E
 Total escape to nearest Final Exit DR9 = 12.3m
 The total escape distance is less than 15m and thus complies.

Position F
 Total escape to nearest Final Exit DR9 = 10.6m
 The total escape distance is less than 15m and thus complies.

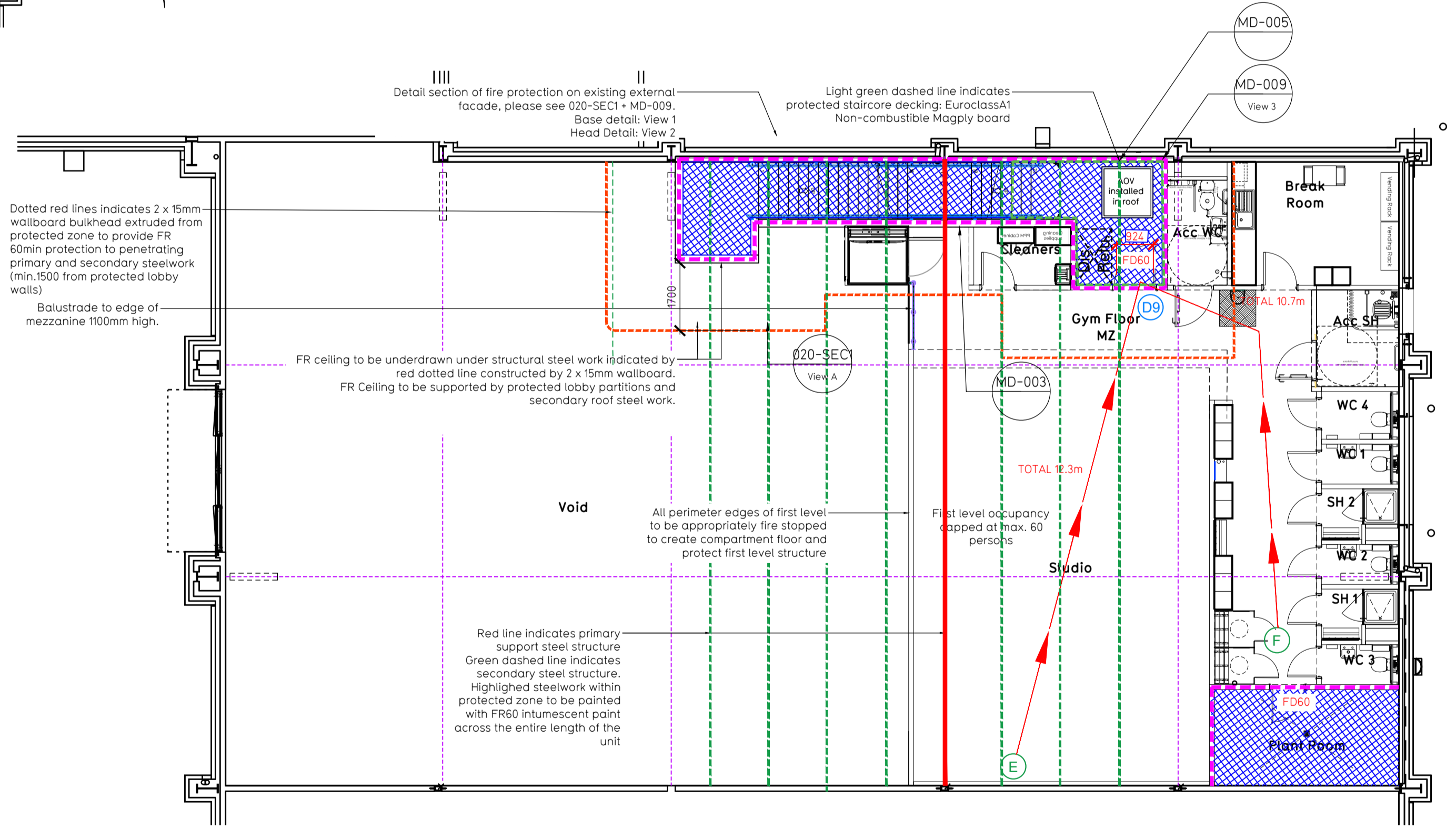

Proposed First Floor Plan

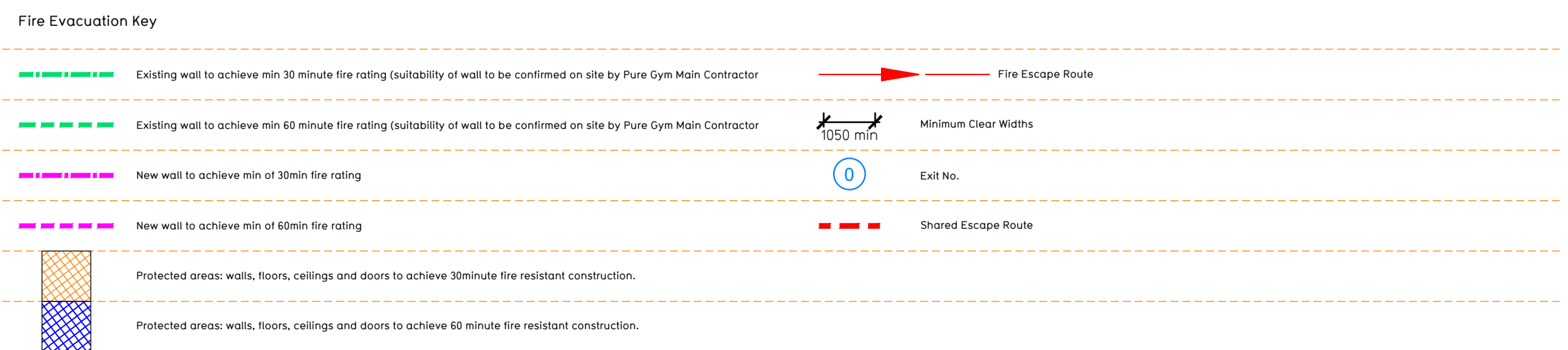

Sprinklers
 System design and installed in compliance with BS EN 12845:2015 & LPC Technical Bulletins

Fire Alarm
 Fire Alarm designed and installed to BS 5839: Smoke & heat detection / emergency lighting by specialist. Please refer to MSE engineer's drawings / specifications.

Escape Lighting
 Emergency escape lighting designed and installed in accordance with BS 5266: Part 1. Please refer to MSE Engineer's drawings for final layout and specification.

Smoke Extract
 Smoke Extract System to be designed and installed in accordance with BS 7346: Part 8. Please refer to MSE Engineer's drawings for final layout and specification.

Escape Signage and emergency lighting is CDP under the MSE specification. Details of contractors proposals to be provided to Building Control Approved Inspector and Fire Officer within the Contractors Proposals Package, Clause 1.4

DELETE ABOVE SECTIONS AS NECESSARY DEPENDING UPON WHETHER RELEVANT TO SITE AND DELETE THIS TEXT

Rev	Date	Description	Drawn / Checked

PROJECT TITLE
 Lidlithgow Unit 2, Stockbridge Retail Park, EH49 7AS

DRAWING TITLE
 Fire Evacuation Plan Ground and Mezzanine Floor Plans

DATE 28.04.23 **SCALE** 1:100 @ A1 **NO** 1046 **REV** 003-FEP

DRAWING PURPOSE
 CONSTRUCTION

Rev C00

PUREGYM

Pure Gym Ltd
 Town Centre House
 The Merrion Centre
 Leods
 LS2 8LY

e: architecture@puregym.com
 t: 0113 285 8787
 w: www.puregym.com